



It's a quick way to print from your device anywhere on campus

Students can send assignments and handouts to the print que anytime

Once it's in the que, just walk up to the printer, input your ID number, and print!

We're always available at:  
[ComputerDepartment@oths.us](mailto:ComputerDepartment@oths.us)

# How to get Mobility Print

## Have One of our Devices?

PaperCut is already installed (If it isn't, please restart your device)

## Need to Print from Your Own Device/Phone?

Mobility Print works on Windows 10 devices or higher, on Macs of IOS 11 and higher, and most smartphones

Simply [download the app using our link](#) and follow the instructions shown

Link:

<https://papercut.oths.k12.il.us:9164/setup>

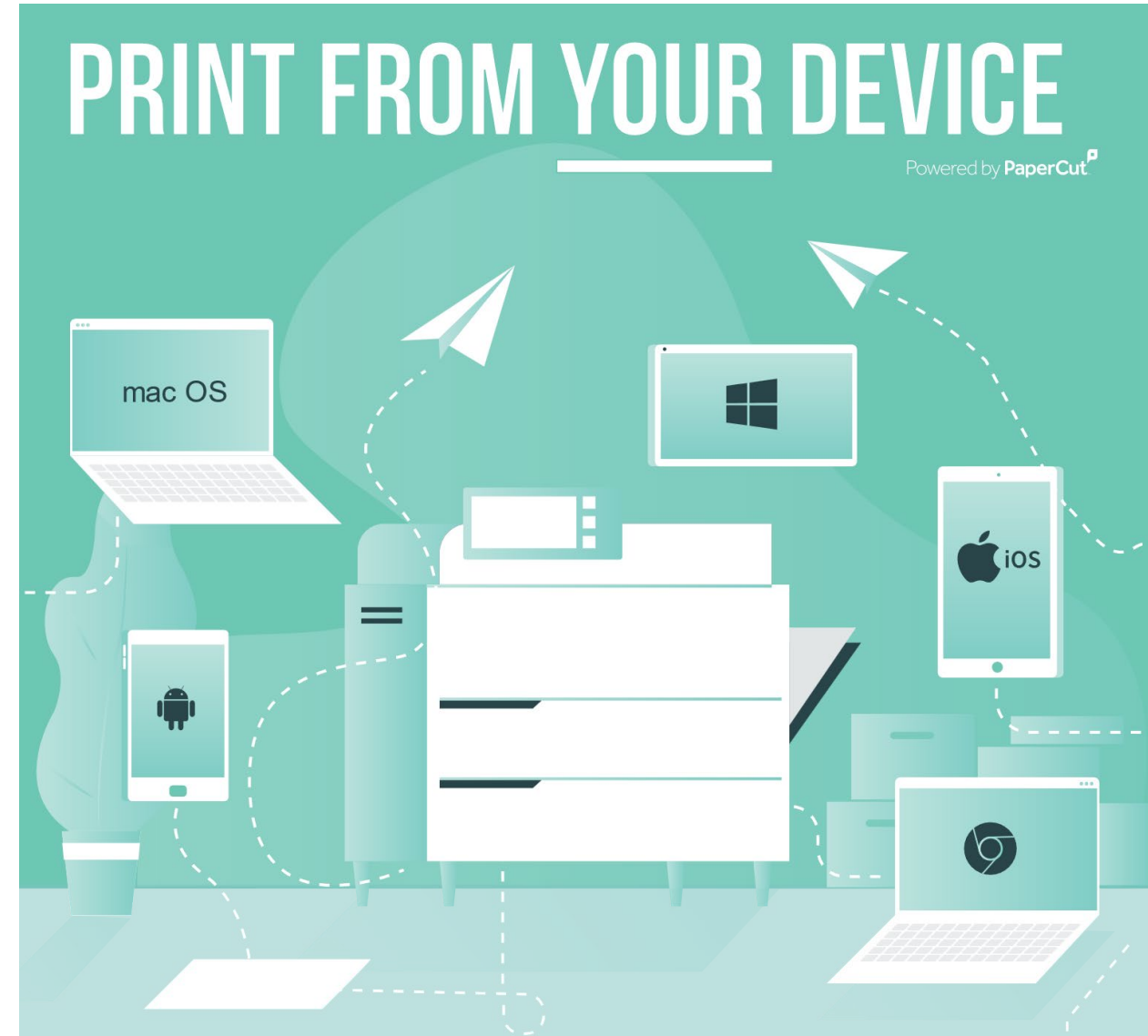

# How to Print with Mobility Print

- Print to one of the printers with Mobility Print's logo →
  - Use BW\_Classroom\_Brother\_Printer for black and white prints
  - Use Color\_Smiley\_IMC\_Xerox for color (Smiley Campus Only)
- Login to Mobility Print using your school issued email and password
- When you're ready to print, walk up to the printer, and input your student ID number
- Walk away with your assignment!



# Mobility Print Locations

## Color Smiley IMC Xerox (Smiley Only)

- Only Color printer
- Located in Smiley's IMC

## Black and White Classroom Brother Printer (Milburn locations)

- Room 1509
- Room 1513
- Room 1515
- Room 1516
- Room 1517
- Room 2510
- Milburn IMC

## Black and White Classroom Brother Printer (Smiley Locations)

- Room 113
- Room 210
- Room 211
- Room 212
- Room 410
- Room 805
- Room 808
- Room 1007
- Room 1011
- Room 1025